

ISSUE/REVISION		
I/R	DATE	DESCRIPTION
P2	02.10.2023	Issued for Planning
P1	13.01.2023	Issued for Planning

PROJECT NUMBER

05-828

SHEET TITLE

Site Compound Details
 & Access Road Details.

SHEET NUMBER

05828-DR-187

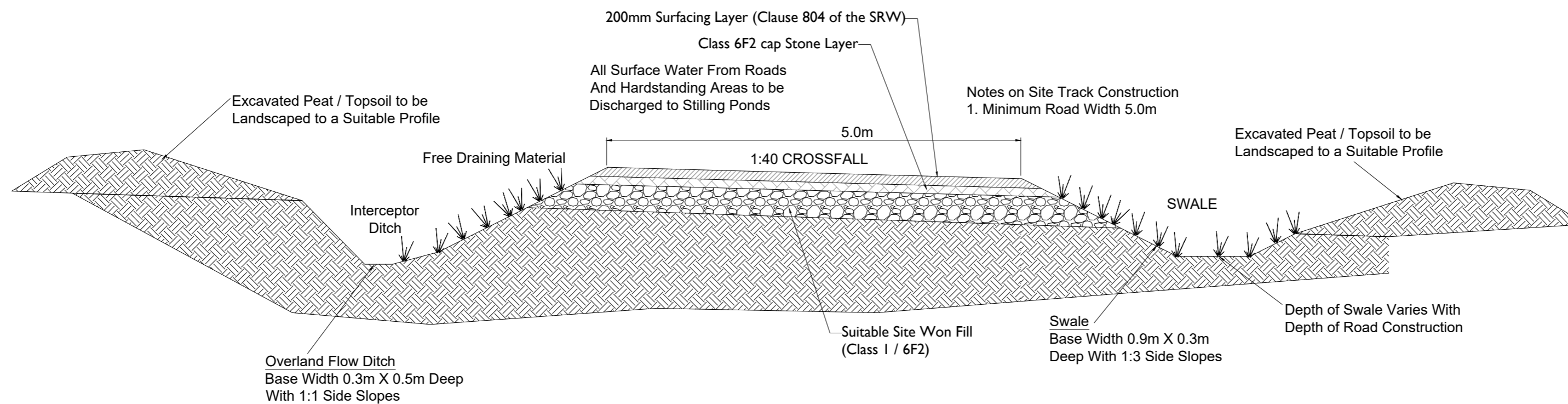

Typical Section Thru Access Road
 SCALE 1:50

- Contraction joints should comprise of the following:
- A sawn groove joint 10mm wide at least $\frac{1}{4}$ the slab depth
 - Dowel bars shall be 20mm \varnothing at 300mm spacing conforming to IS EN 10060 and IS EN 13877-3 with a minimum tensile strength of 250 MPa
 - A sealing groove (seals shall be hot applied sealants Type N1 or Type F1 complying with IS EN 14188-1 and applied in accordance with BS 2499-2)

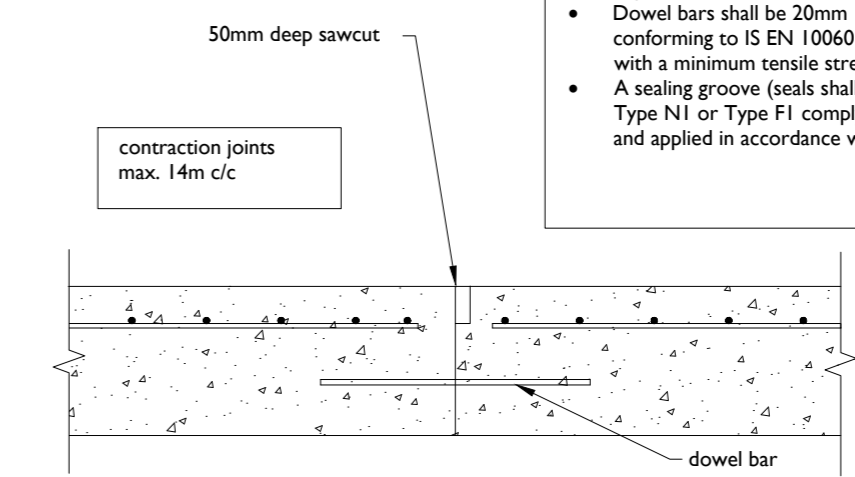

Concrete Access Road Contraction Joint
 SCALE 1:10

- Expansion joints should comprise of the following:
- A joint filler board 25mm thick self expanding cork seal or from another approved compressible material
 - Dowel bars in an approved sheath shall be 25mm \varnothing at 300mm spacing conforming to IS EN 13877-3 with a minimum tensile strength of 250MPa
 - A sealing groove as above

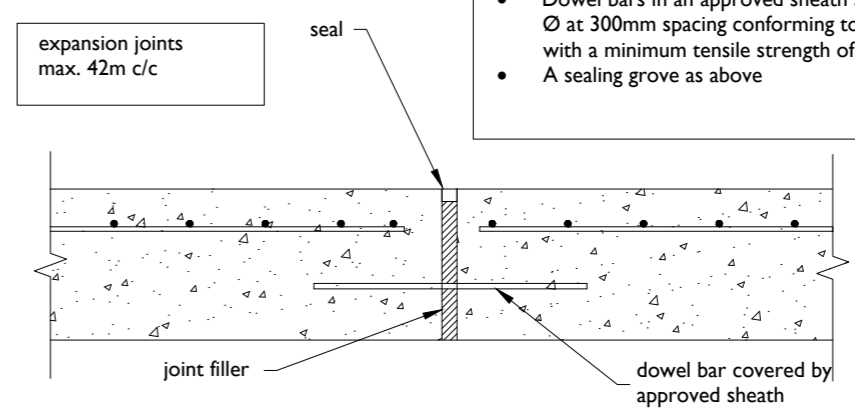

Concrete Access Road Expansion Joint
 SCALE 1:10

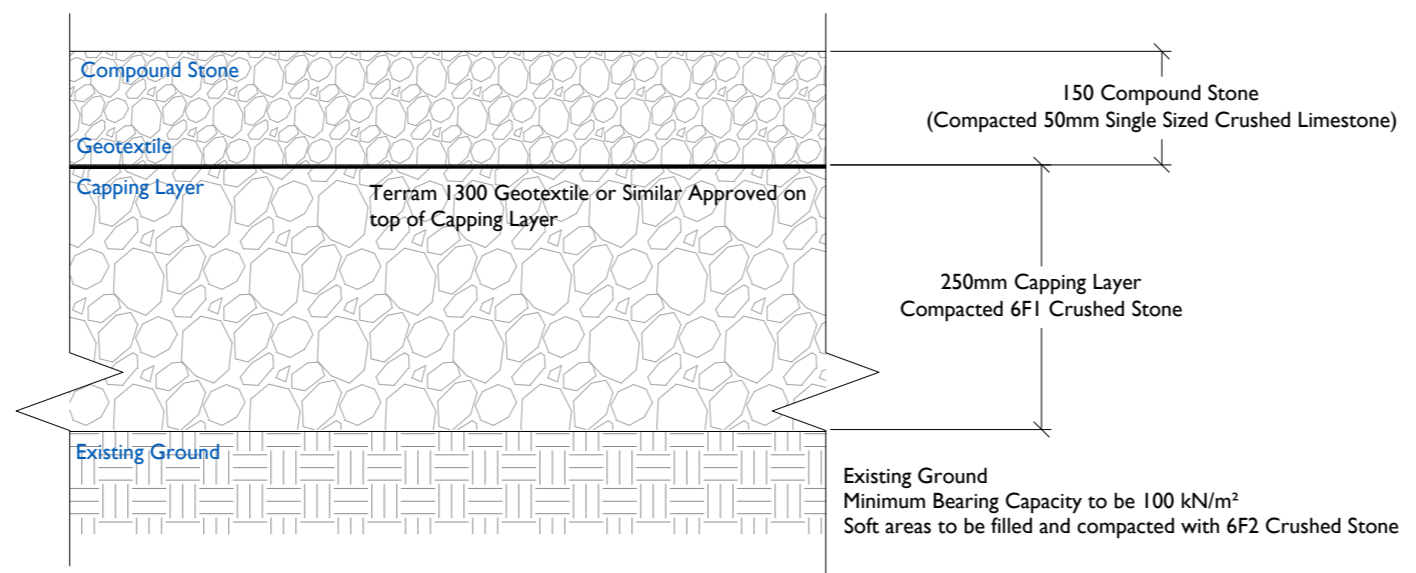

Typical Compound Detail
 SCALE 1:10

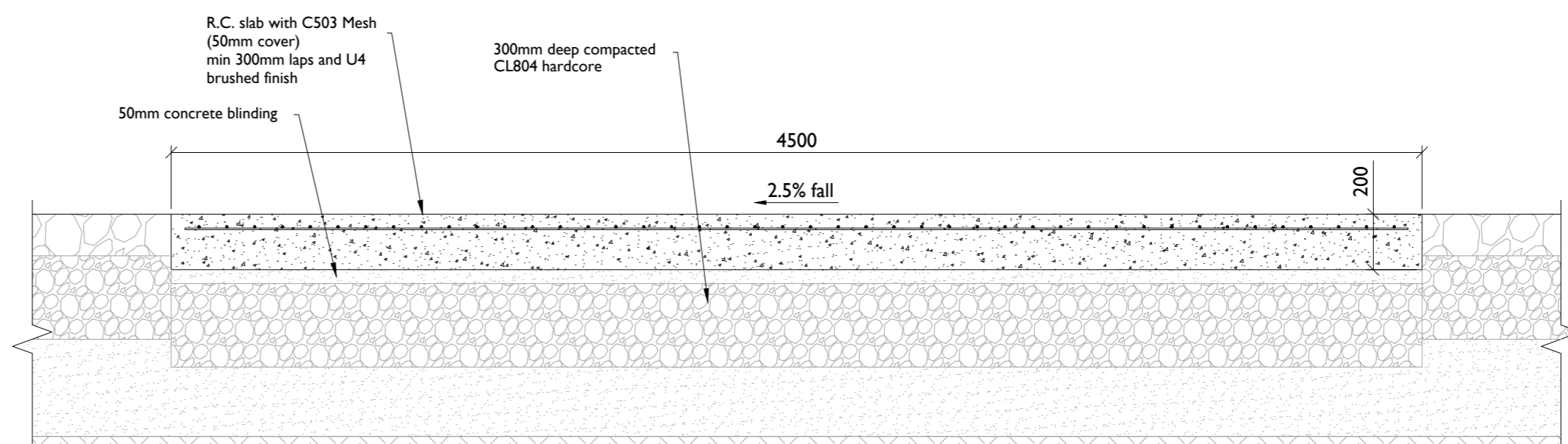

Typical Section - Concrete Access Road
 SCALE 1:20

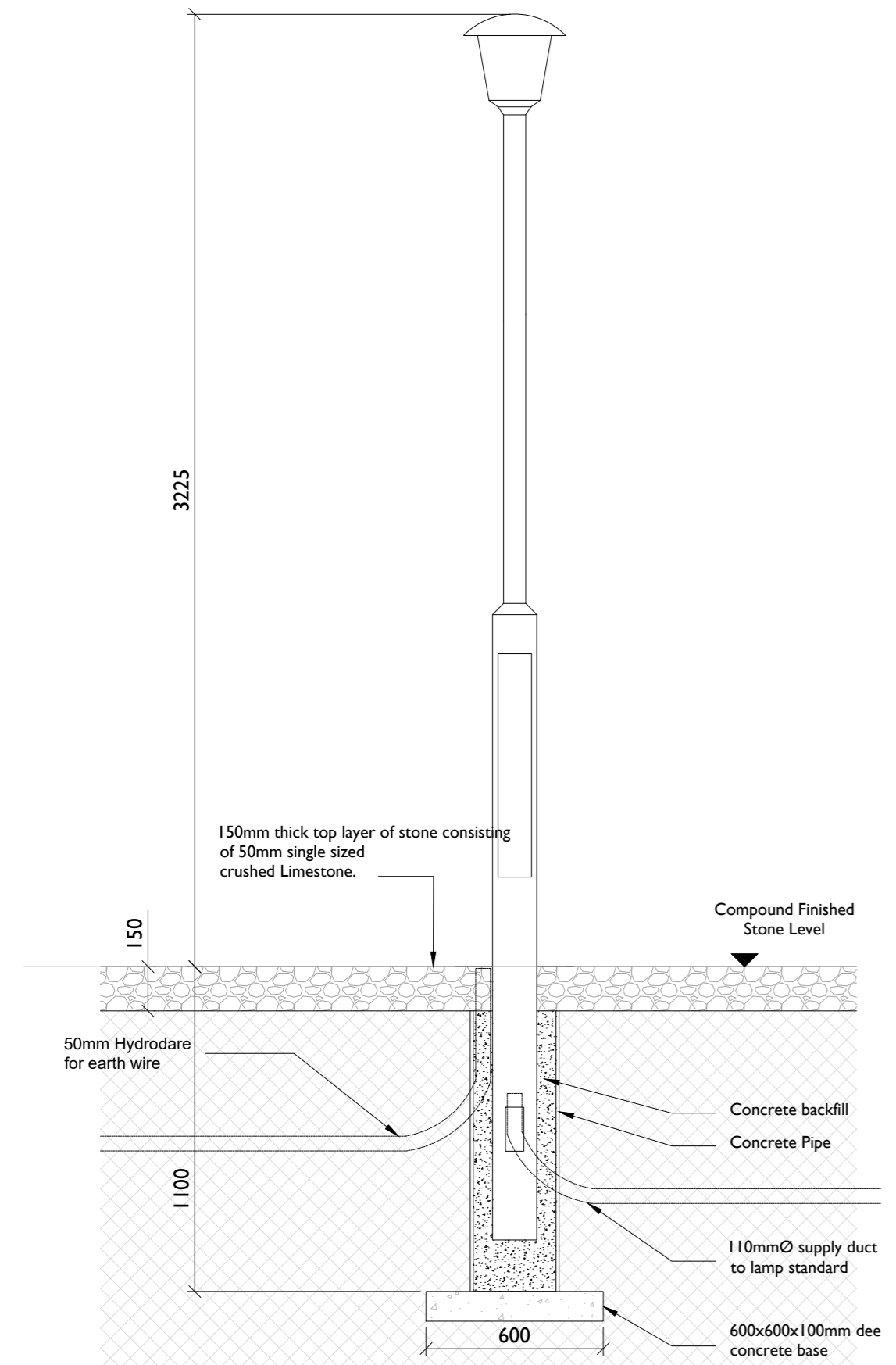

Lighting Column & Surround Detail
 SCALE 1:20